



Class 5 Torque Tool ISO Fig 18

This torque tool has been specifically developed to provide the highest level of performance using a high specification motor and robust gearbox in an efficient, low weight assembly. The socket is specially profiled for easy alignment. A range of control accessories is available including a precision surface torque verification unit for pre-dive testing.

The tool conforms to the ISO "class 5" interface style used extensively in the subsea industry for pipeline valve operations by ROV. The tool uses a high specification drive motor for consistent torque output characteristics.

Features

- ISO 13628-8 Fig 18 Class 5
- 6750 Nm/5000 ftlbs Max
- Low Weight

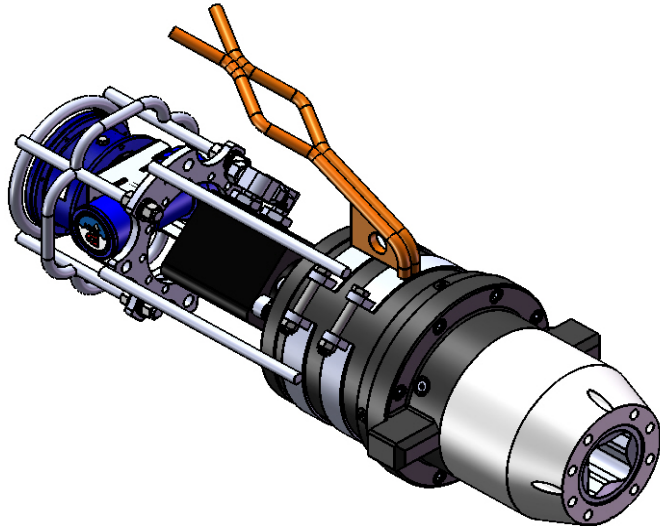

Specifications

Standard Interface:	ISO 13628-8 Fig 18
Socket Size:	2" Square
Maximum Torque:	6750 Nm (5000 ftlbs) @ 140 Bar (2000 psi)
Recommended Range:	1350-6750 Nm (1000-5000 ftlbs)
Motor Size	315 cc Fluid Ports ¼" SAE
Materials	Steel Motor and Gearbox, Duplex Socket, Aluminium Housing, Plastic Nose
Weight:	54kg in air/41kg in Water (119lbs/90lbs)
Hydraulic:	Mineral Oil
Sensors:	Dual Turns count sensor (inductive)
Electrical:	8 Pin Connector

What's in the box

A019-778-302/03

- Torque Tool.
- Fish tail Handle.
- Universal Subsea Display.
- USD Battery Pack.
- USD Battery Charger.
- Interconnect Cables.

Dimensions

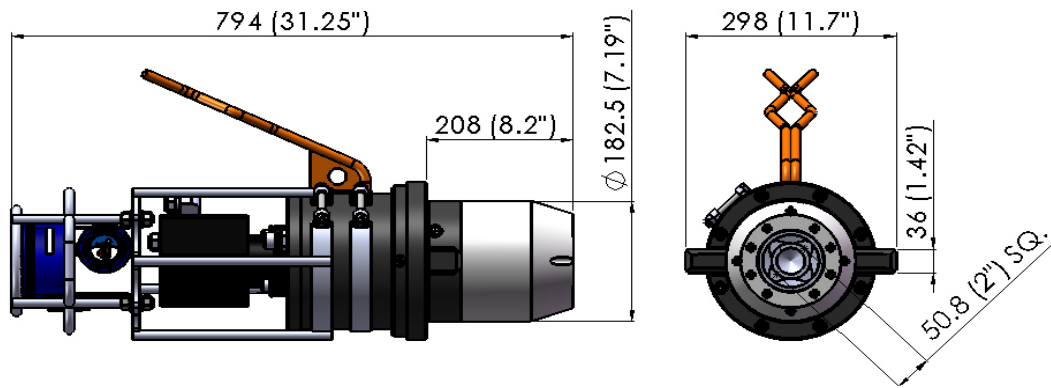

Part Numbers & Options

- A019-778-302/03 Class 5 Torque Tool, case, hoses, handle.
- A019-994-301/s Class 5 Spares Kit.
- TX00111-100-00 Class 5 Surface Verification Unit.
- A286-001-050/04 Torque Tool Control System. (Note will not work in conjunction with USD)
- A019-901-102 3 Stage Manifold. (Use instead of Torque Tool Control System).

Data Sheet: A001-350-036 issue 9

The specification details are illustrative for marketing purposes only. Actual equipment may be different as a result of product improvement or other reasons. Specific interface and performance information should be reconfirmed at time of order placement.