



# Multifluid Pump

The multifluid pump is a self-cycling double piston hydraulic unit. The assembly includes an internal directional valve and a pressure tolerant auto-reverse electrical timing circuit. It simply requires driving oil supply and a 24V signal from the ROV.

An alternative option is available for an all hydraulic pump, this requires no electrical current to operate, only supply and return pressure.

The system was developed for the specific needs of both reliable fluid injection and deepsea buoyancy tank pumping from an ROV. It has specific ROV details such as double barrier sealing with venting, debris tolerance and materials for seawater use. It can operate either as a normal pump to deliver high pressures or as a suction pump to deliver high relative suction in deep sea conditions.

## Features

- High Pressure or Suction
- +/- 300 Bar
- 3000 m Rated
- Light Weight (26 kg in water)

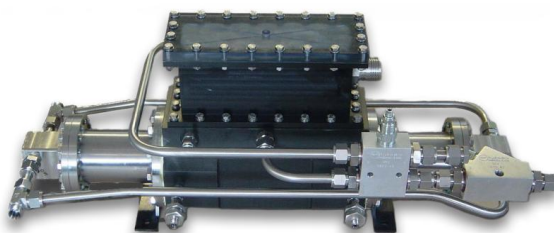

Electrically Controlled Version.

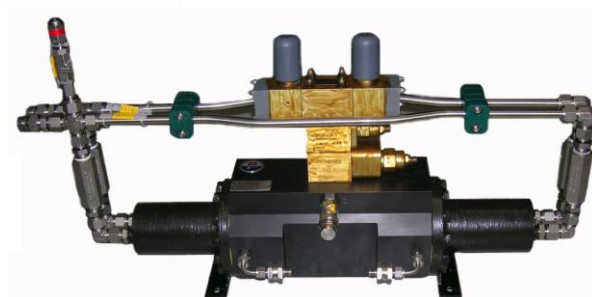

Hydraulically Controlled Version.

Dimensions for Electrically Controlled Version

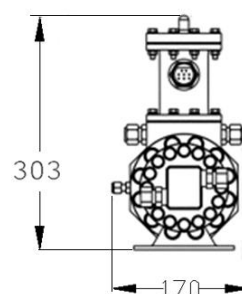
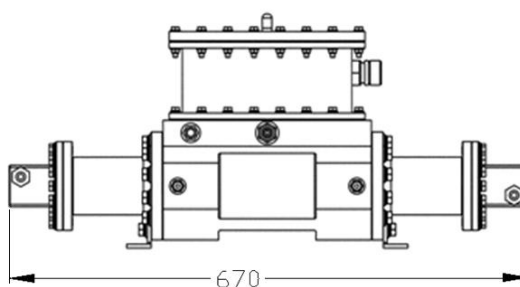

Dimensions for Hydraulically Controlled Version

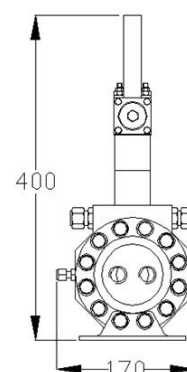
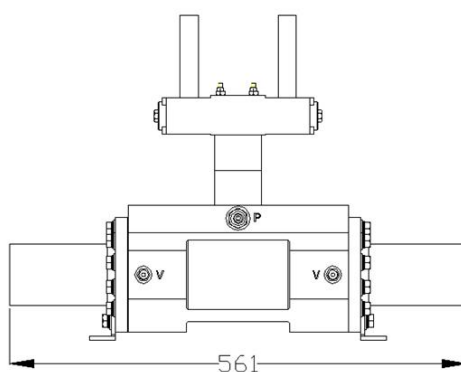

Specifications		Options
Weight in air:	36 kg (including external pipework and valves)	<ul style="list-style-type: none"> <li>■ Pumps can be produced in alternative intensification ratios and displacements</li> <li>■ All hydraulic operation option.</li> <li>■ 24Vdc operation option</li> </ul>
Weight in seawater:	32 kg (including external pipework and valves)	
Depth Rating:	3000 m	
Pressure Intensification:	2:1	
Swept Volume:	237 cc per water chamber	
Cycle Rate:	33/minute (A & B chambers full cycle) 66/minute half cycle	
Input Oil Rate:	30 lpm minimum (essential)	
Input Oil Pressure:	200 bar nominal	
Output Water Flow:	(with 30 lpm and 195 Bar relief setting on oil input). Figures are similar for suction or pumping 16 lpm up to 300 bar 10 lpm up to 330 bar (stall at 360 Bar)	
Fluid Compatibility:	Water based solutions including: - The standard seals are suitable for freshwater, seawater, HW540, Transaqua HT and similar water glycol solutions -Check with PSSSL for specific fluid compatibility on other fluids or high temperatures	
Materials:	Marine grade Stainless Steel and Anodised Aluminium	
Hydraulic Connections:	JIC or Swagelok fittings	
Electric Operation		
Connector:	25 Vdc at 0.9A	
Supply Voltage:	Bulkhead 5507-2008	
Data Sheet: A001-350-033 issue 7		

The specification details are illustrative for marketing purposes only. Actual equipment may be different as a result of product improvement or other reasons. Specific interface and performance information should be reconfirmed at time of order placement.