



ROV Operated Ball Valve

The ROV ball valve is suitable for panel mounting into client structures. The stainless steel and plastic mechanisms are self-lubricating and permit a strict 90° rotation, limited by robust end stops. The ball valve stem is protected from bending, axial and rotational overload from the manipulator grip. The handle is suitable for operation by most types of seven function robotic manipulators.

The design is available in sizes from 1" to ¼" and working pressure ratings to 10,000 psi (700 bar).

Features

- Manipulator/Torque Tool Interface
- Up to 1" Ball Valve
- Panel or Flush Mounting
- Corrosion Resistant
- Housing protects valve from accidental damage

Standard Valve

Part # A287-050-002



Dimensions

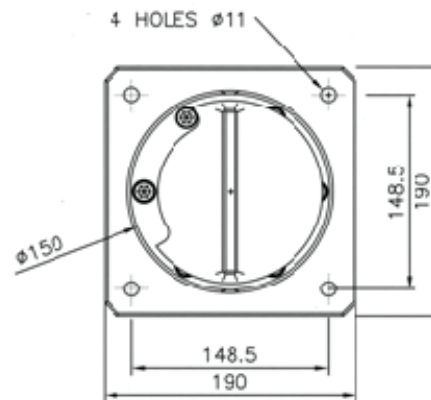
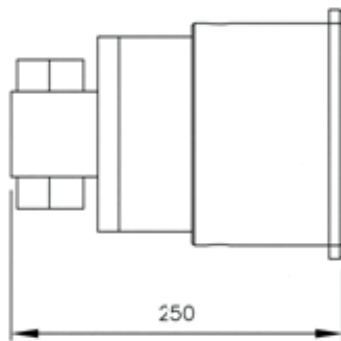

Options

- Alternative Valve Sizes

Data Sheet: A001-350-031 issue 7

The specification details are illustrative for marketing purposes only. Actual equipment may be different as a result of product improvement or other reasons. Specific interface and performance information should be reconfirmed at time of order placement.